



Strode Street, Egham, Surrey TW20 9BU

PRICE ON APPLICATION

**BARON**

ESTATE AGENTS



Niche Communications

DRAFT COPY FOR PROOFING PURPOSES ONLY



Strode Street, Egham,  
Surrey TW20 9BU  
PRICE ON APPLICATION  
EPC: E

This ground floor student maisonette is located in central Egham, and is within walking distance to the station, high street and Royal Holloway University. Benefits include three bedrooms, living room, kitchen, bathroom and ample parking.

- CENTRAL EGHAM
- GROUND FLOOR
- THREE DOUBLE BEDROOMS
- ALLOCATED PARKING
- WALKING DISTANCE TO THE STATION
- LARGE KITCHEN AND LIVING ROOM

## Spacious three bedroom ground floor maisonette in central Egham.

For more information or to arrange a viewing please contact:

Baron Residential Ltd  
Milton House, 27 Station Road  
Egham, Surrey, TW20 9LB

T: 01784 473844  
E: info@baronresidential.com

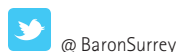

# BARON

[WWW.BARONRESIDENTIAL.COM](http://WWW.BARONRESIDENTIAL.COM)

ESTATE AGENTS

APPROX. GROSS INTERNAL FLOOR AREA 774 SQ FT 71.9 SQ METRES

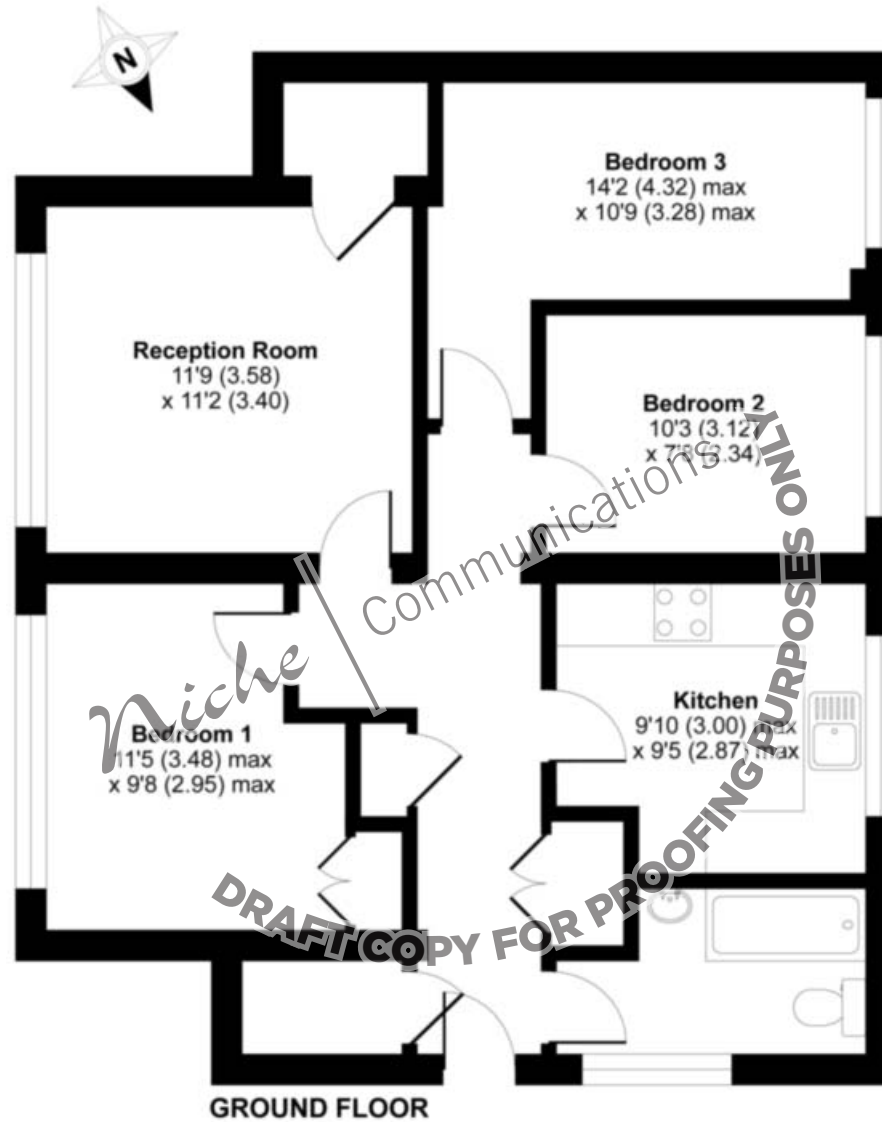

Whilst every attempt has been made to ensure the accuracy of the floor plan contained here, measurements of doors, windows and rooms are approximate and no responsibility is taken for any error, omission or misstatement. These plans are for representation purposes only as defined by RICS Code of Measuring Practice and should be used as such by any prospective purchaser. Specifically no guarantee is given on the total square footage of the property if quoted on this plan. Any figure given is for initial guidance only and should not be relied on as a basis of valuation.

**BARON**